



Technical drawing of a 300mm diameter steel plate with a central hole and a flange. The drawing includes a side view and a top view.

**Side View Dimensions:**

- Total height: 1490mm
- Central section height: 1200mm
- Flange thickness: 180mm
- Central hole diameter:  $\varnothing 12\text{mm}$
- Flange outer diameter:  $\varnothing 60.3\text{mm}$

**Top View Dimensions:**

- Plate diameter:  $\varnothing 300\text{mm}$
- Central hole diameter:  $\varnothing 12\text{mm}$
- Flange outer diameter:  $\varnothing 60.3\text{mm}$
- Flange thickness: 180mm

**Labels:**

- VIJAK M8 ZA TRAKU UZEMLJENJA (Screw M8 for grounding strap)
- pocičani č. plosnati profil (flah), d=5mm (Cold-chamber die cast flat profile (flange), d=5mm)

**Razvijeni pocičani č. plosnati  
profili (flah) d=5mm**

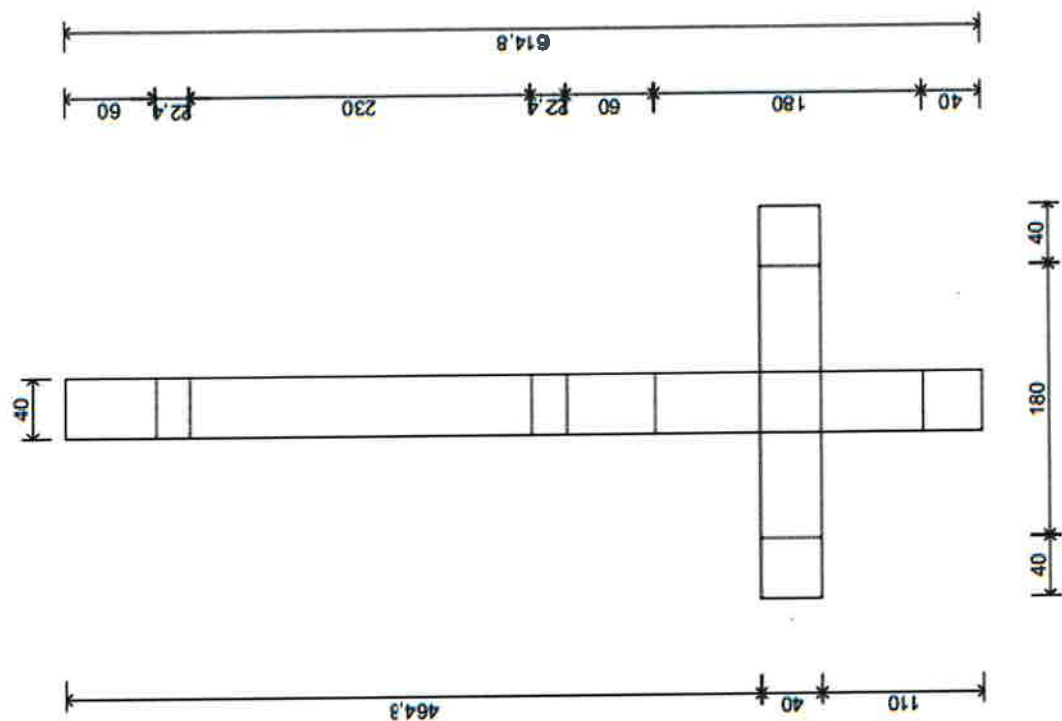

**mjere su u mm**



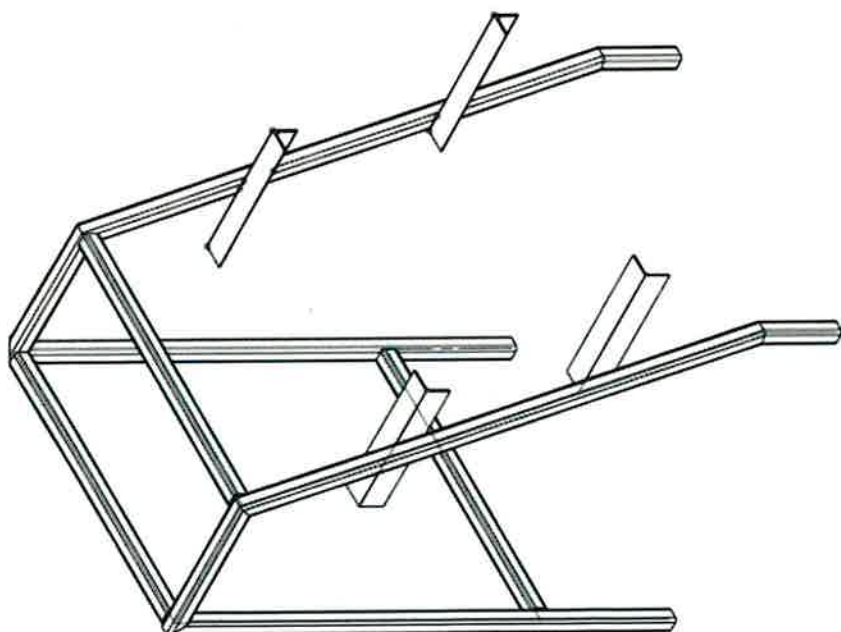
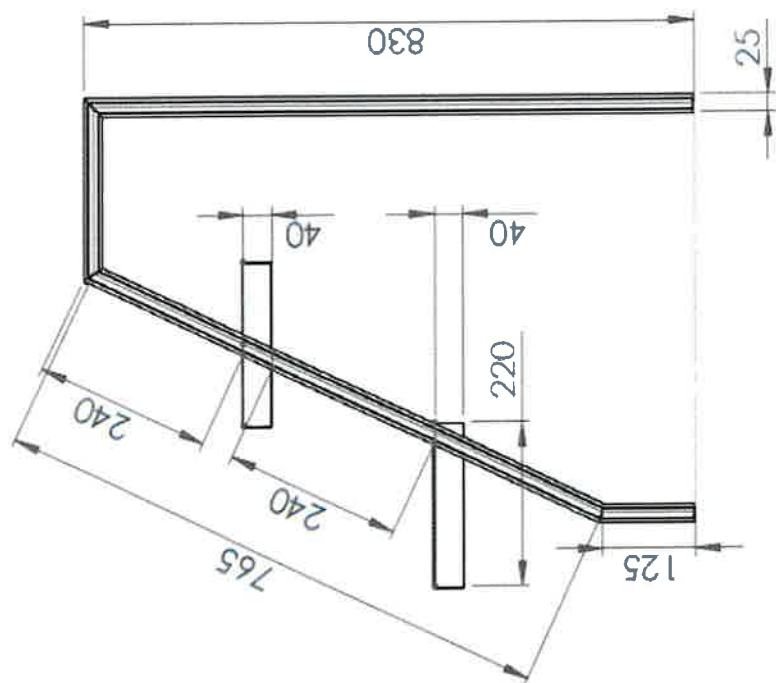
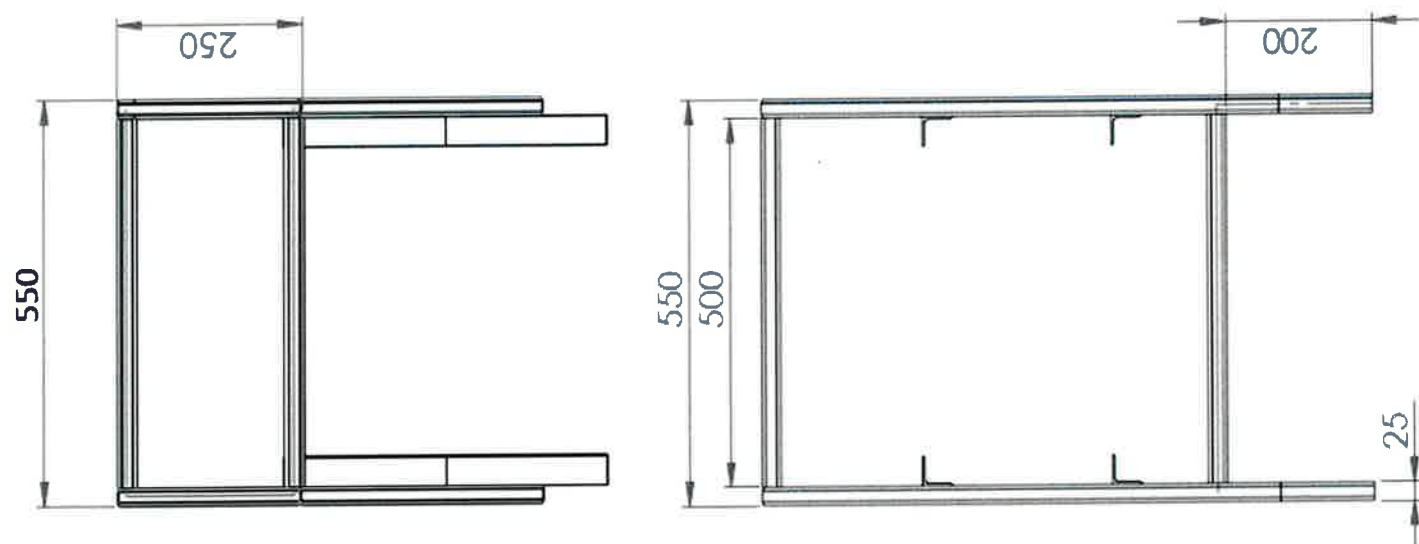

Stavka 4 Nosnaž oazišta stenenira

Gazište "A" 550/250; 30/2; 33X33

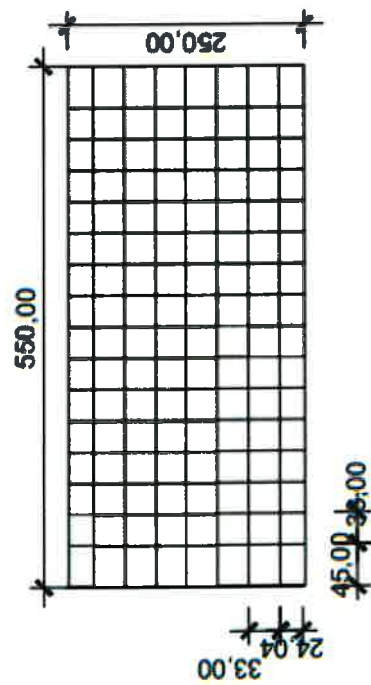

Gazište "B" i "C" 550/250; 30/2; 33X33

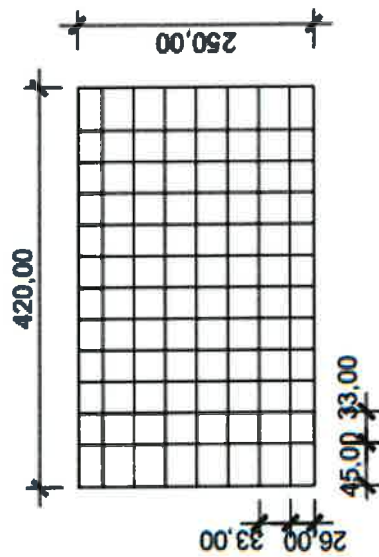

Stavka 5. Gazišta za stepenice







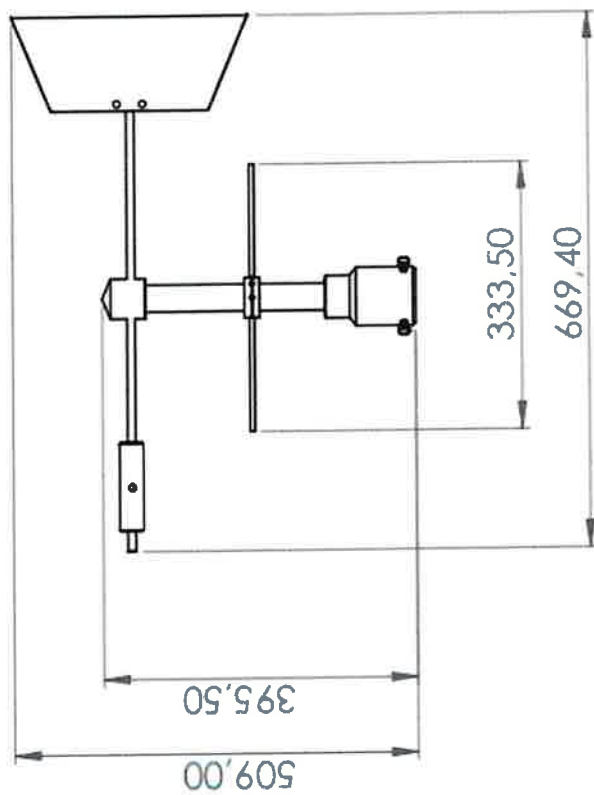
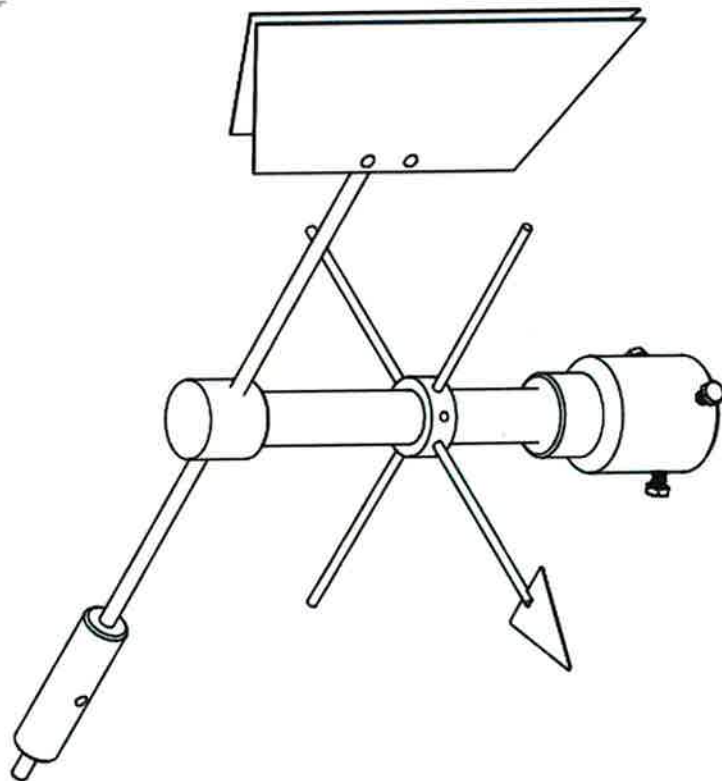
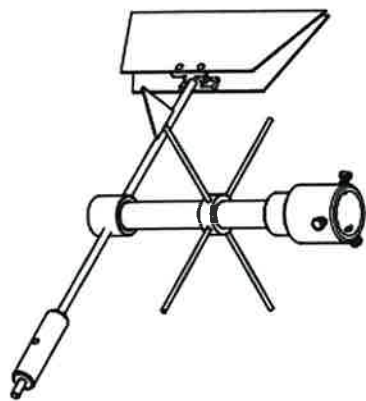
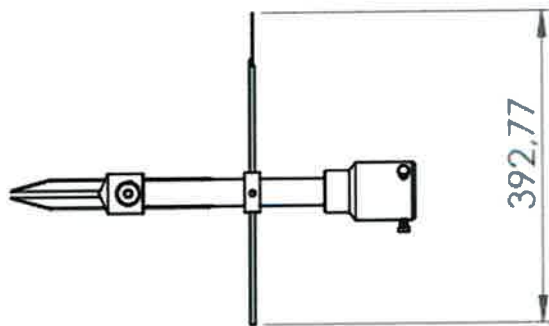
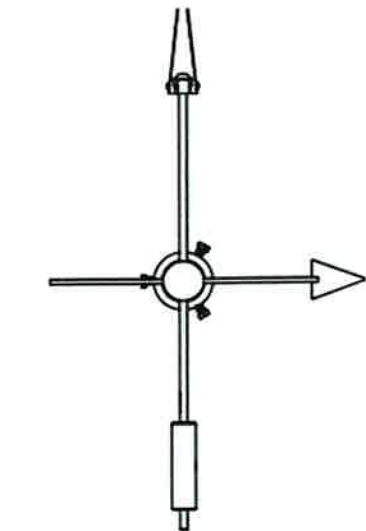

Stavka 7. Glava vjetrokaza s križem i redukcijom

